

# High Accuracy GNSS Active Antenna GL241

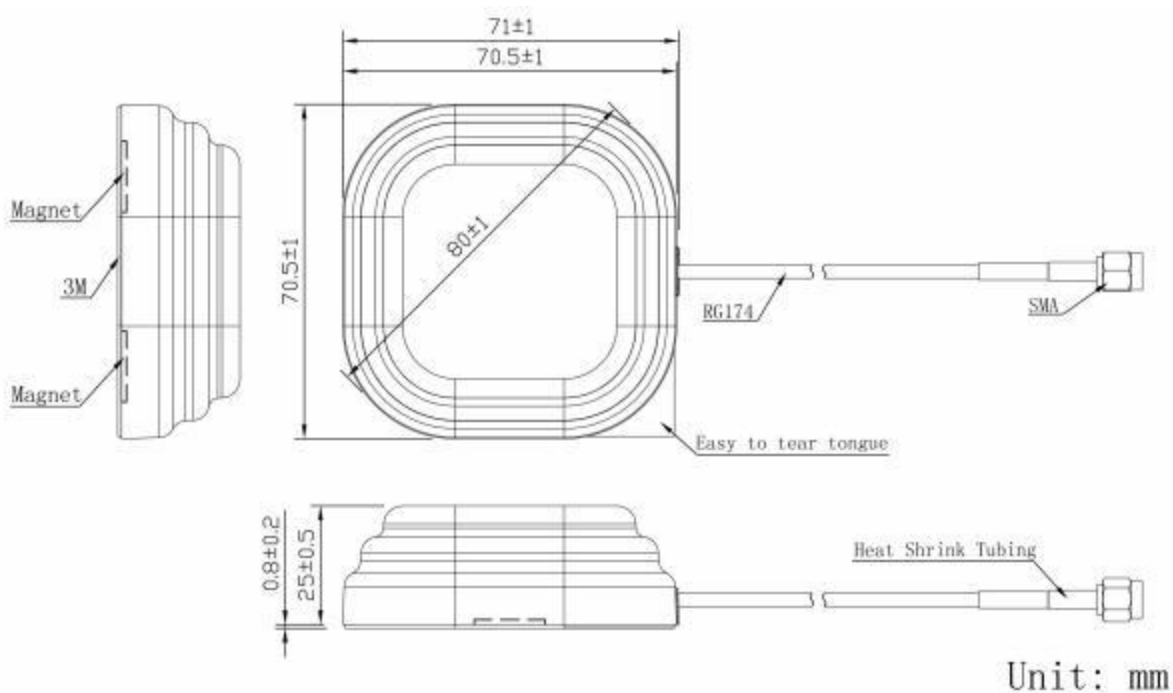

## DIMENSIONS



## SPECIFICATIONS

Item		Specifications
Antenna (4+4Pins)	Frequency	GPS L1/L2/L5 GLONASS G1/G2/G3 COMPASS B1/B2/B3 Galileo E1/L1/E2/E5a/E5b
	Polarization	RHCP
	Axial Ratio(min)	≤3dB
	V.S.W.R	≤2.0
	Peak Gain	≥3dBic
	Impedance	50 Ω
	Horizontal coverage angle	360°
LNA	Gain	28±2dB
	Noise Figure	≤1.5dB
	Supply Voltage	3~12V DC
	Current Consumption	≤50mA
	V.S.W.R	≤2.0
Mechanical	Connector	SMA or others
	Cable	RG174 or others
	Mounting Method	Magnet/Adhesive
Environmental	Operating Temperature	-40℃~+85℃
	Relative Humidity	Up to 95%
	Ingress Protection	IP66
	Vibration	10 to 55Hz with 1.5mm amplitude 2hours
	Environmentally Friendly	ROHS Compliant

## Radiation Pattern

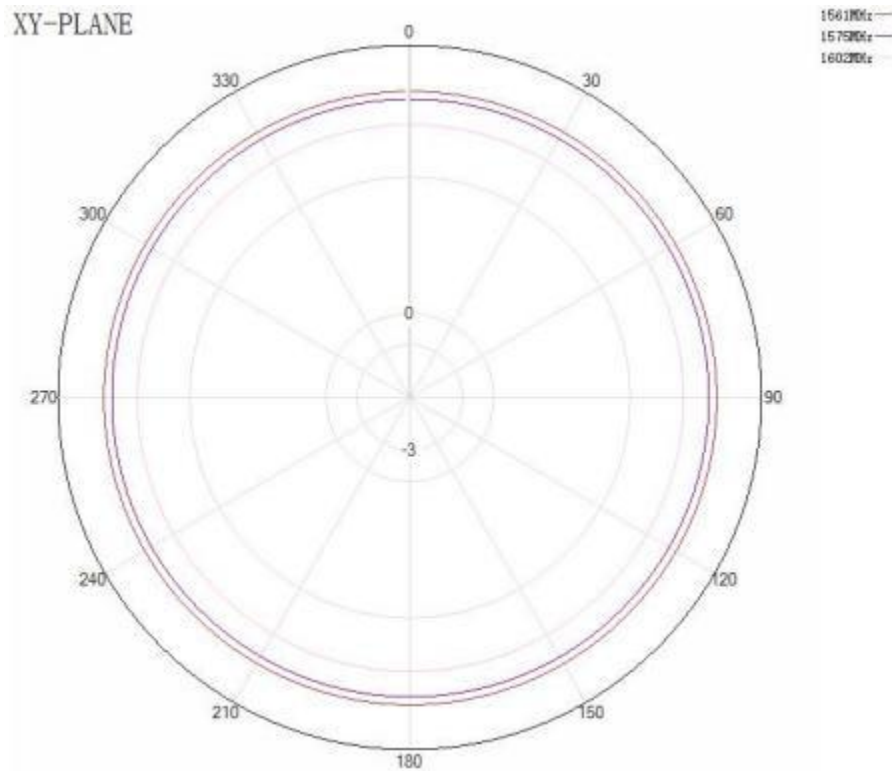
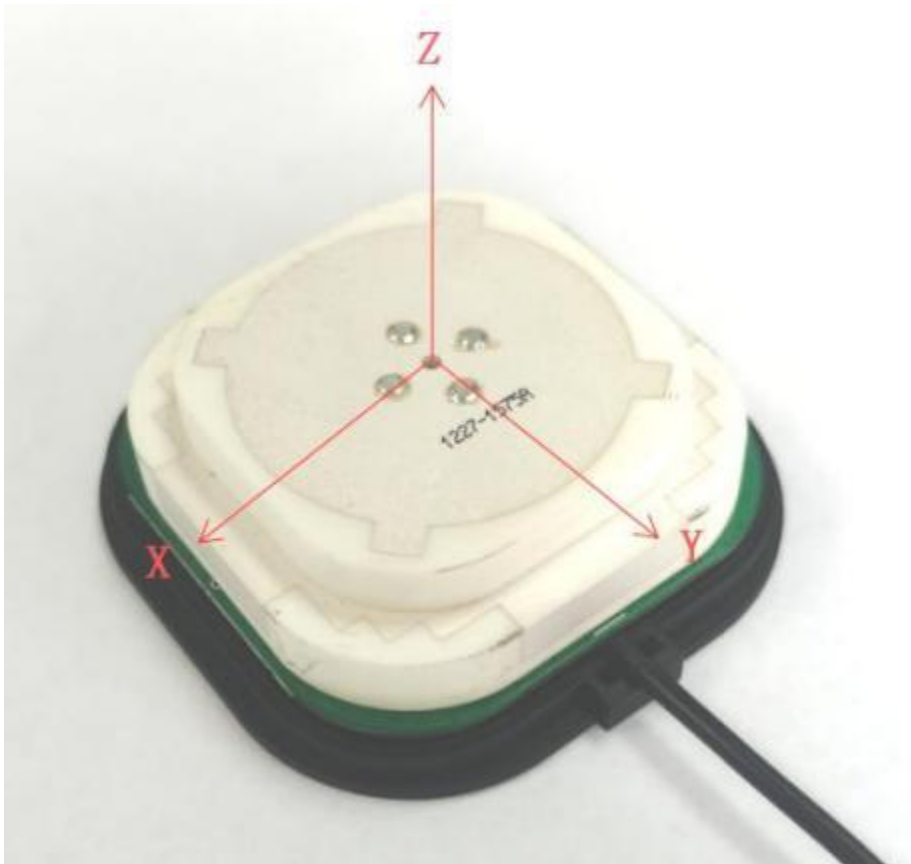

**Add:** Room 816-818, Block B,BLDG 18, University Science Park(East), Zhengzhou City,P.R.Henan,China. Zip Code: 450051

**Tel:** 86-371-60911368

**Email:** [info@global-antenna.com](mailto:info@global-antenna.com)

XY-PLANE

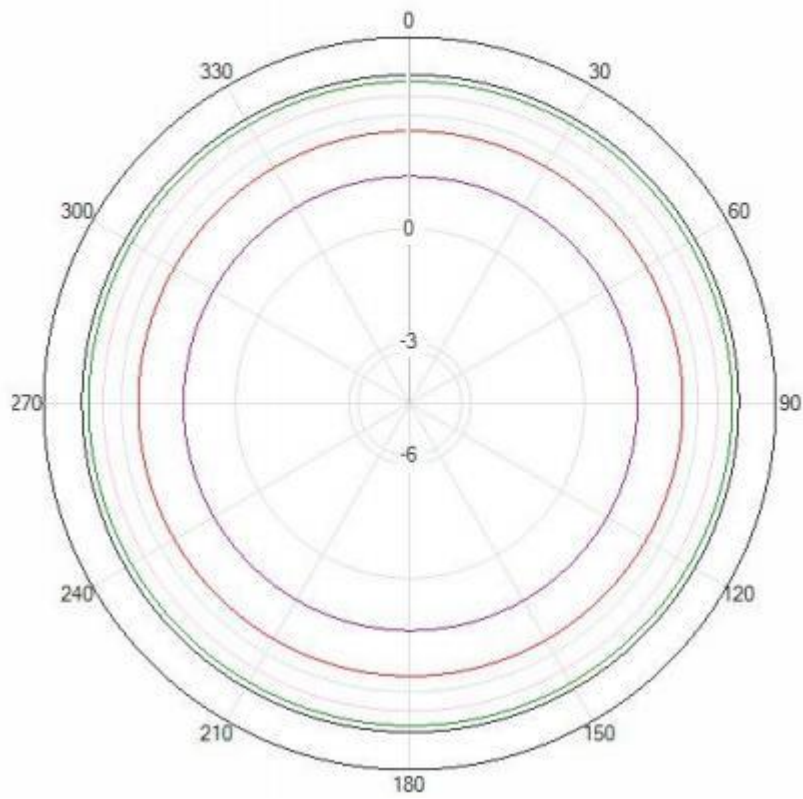

XZ-PLANE

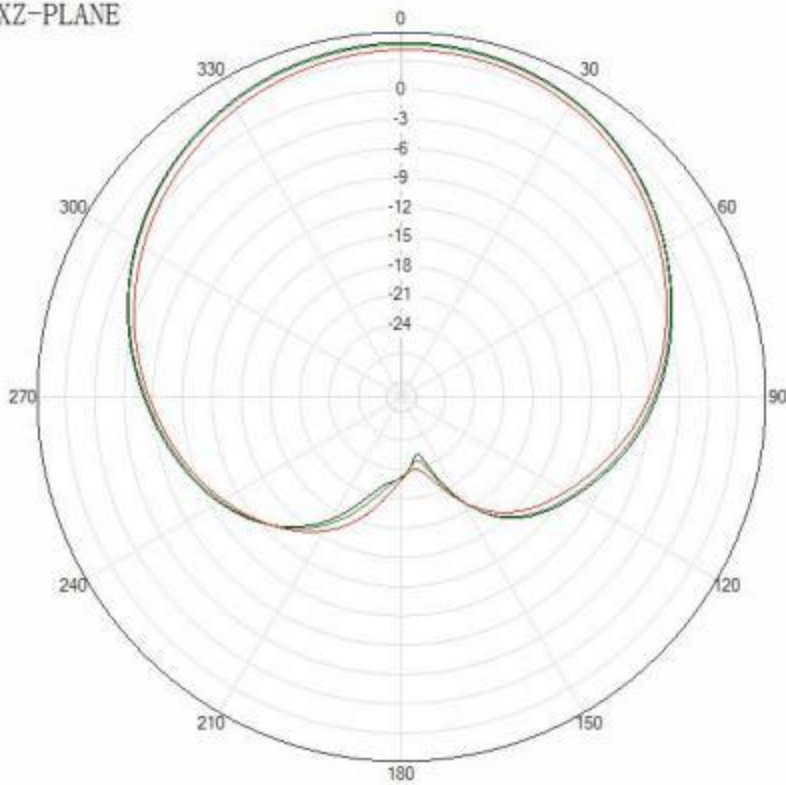

**Add:** Room 816-818, Block B,BLDG 18, University Science Park(East), Zhengzhou City,P.R.Henan,China. Zip Code: 450051

**Tel:** 86-371-60911368

**Email:** [info@global-antenna.com](mailto:info@global-antenna.com)

XZ-PLANE

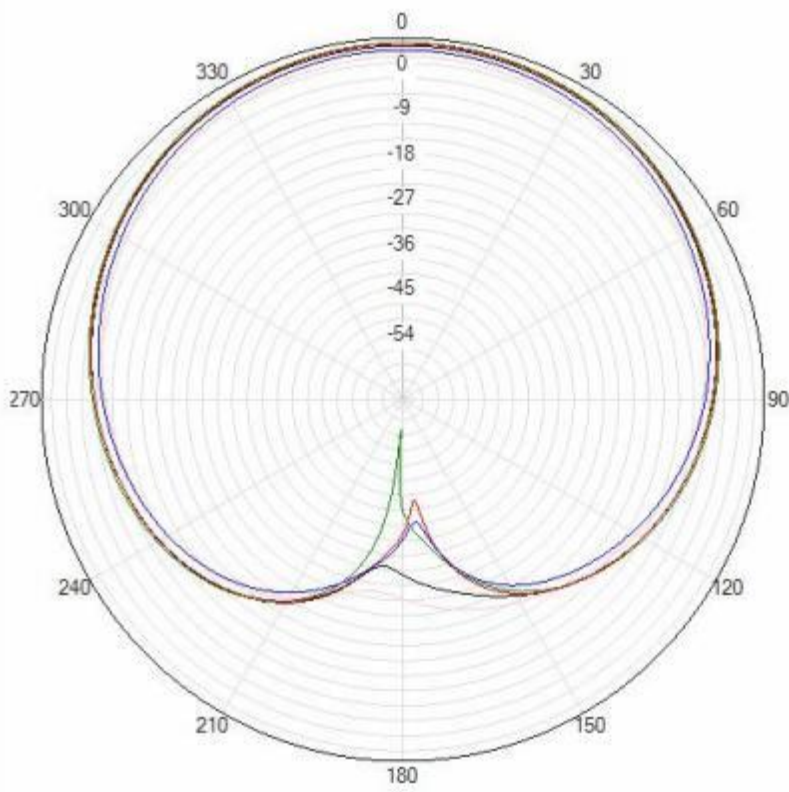

- 1176MHz
- 1207MHz
- 1227MHz
- 1246MHz
- 1268MHz

YZ-PLANE

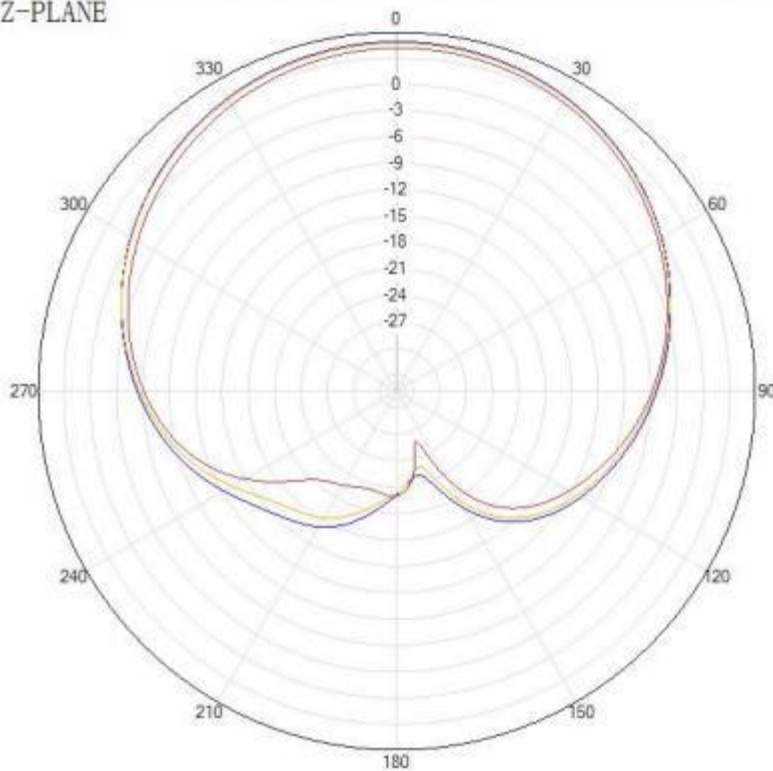

- 1561MHz
- 1575MHz
- 1602MHz

**Add:** Room 816-818, Block B,BLDG 18, University Science Park(East), Zhengzhou City,P.R.Henan,China. Zip Code: 450051

**Tel:** 86-371-60911368

**Email:** [info@global-antenna.com](mailto:info@global-antenna.com)

YZ-PLANE

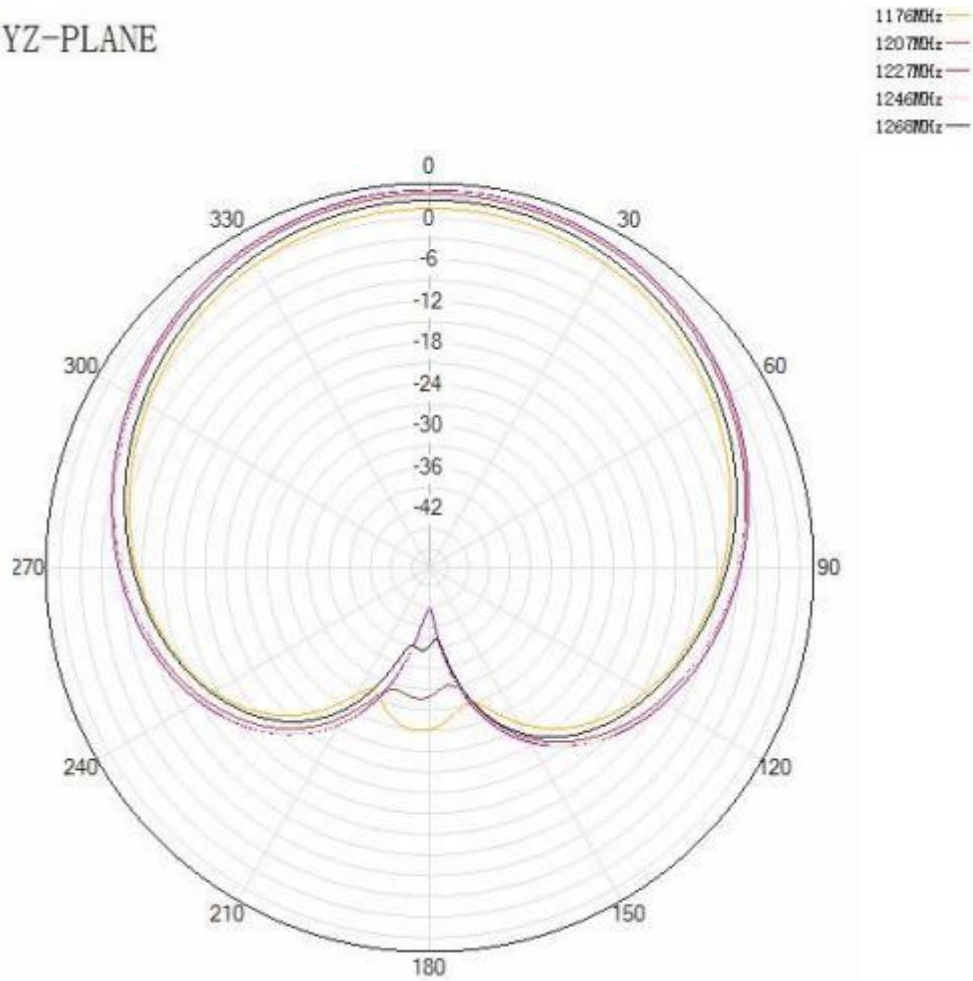

**Add:** Room 816-818, Block B,BLDG 18, University Science Park(East), Zhengzhou City,P.R.Henan,China. Zip Code: 450051

**Tel:** 86-371-60911368      **Email:** [info@global-antenna.com](mailto:info@global-antenna.com)